

CABINETS

BY LOFT



University Loft Company

THE LOFT WAY

Welcome, and thank you for checking out our catalog of quality furniture and related products from University Loft Company. At ULC, we've been at the forefront of innovative furniture design and manufacturing for more than a quarter century, serving college and university, government and military, hospitality, and residential customers. In this catalog you'll find our newest products designed to fit your lifestyle needs today—and designed to last for years to come.

We're committed to producing top-quality furniture that provides the best overall value. By using superior strength materials emphasizing solid wood construction, along with state-of-the-art construction methods, University Loft delivers furniture that stands the test of time. Simply put, we're proud to be an American company manufacturing products in the American heartland. We're also proud to have offices, production facilities and customer markets worldwide where we can expand the reach of American ingenuity, style and quality.

We're committed to being responsive to your unique needs, your individual concerns and your furniture-buying challenges. Whether you are a residential consumer choosing a bedroom set for your growing child, a procurer of furniture for military housing, or a college residence life furniture buyer, we're committed to making your furniture buying experience more satisfying.

When all is said and done, we hope you'll recognize that our business isn't really about furniture; it's about the people who entrust University Loft Company to outfit the personal spaces where they live, work and play. To remain worthy of that trust, we are always learning, always innovating and always improving... our environment, our products and our service. It's what you expect of us and it's what we demand of ourselves.



MORE THAN FURNITURE

UniversityLoftCompanyiscommittedtothemanufacturing of superior constructed and designed furniture at extremely competitive prices, with an unmatched level of customer service.

Our new products feature updated styles and designs and also provide the same quality we've been known for since 1986. It's our mission to create products that can withstand rigorous daily use, but also be innovative, interchangeable, and environmentally friendly.

At University Loft Company, it is our desire to offer our customers the best in service and quality furniture products from college student furniture to kitchen islands, from living room sets to dining tables.

All of our furniture is manufactured with high standards so that we can deliver the best in service and quality furniture products.

Built from some of the hardest wood grown, Hevea Brasiliensis is also kind to our environment. In independent laboratory tests, this wood has surpassed others. But the testament to our product's durability is shown when one generation to the next has been able to use the same furniture.

EAGLE'S LANDING, DAYTONA BEACH, FL

WHERE CLASS MEETS
CONTEMPORARY



EVERY CORNER MATTERS

DOVETAIL TECHNOLOGY

Drawer boxes are constructed with English dovetail joints along with full-extension drawer glides. All drawers are constructed with 4 corner blocks. Each drawer bottom consists of a stretcher for added support.



UNPARALLELED ENGINEERING & TECHNOLOGY

THE SMALLEST DETAIL MAKES THE BIGGEST DIFFERENCE.

Using the best construction methods available, University Loft Company builds the longest-lasting, most durable casegoods on the market. From top to bottom, everything about a ULC casegood is strong. Built completely of solid hardwood, these casegoods will stand the test of time.

THE 1,2,3

STEP BY STEP

1| PLAN

Bring the your ideas to reality through our 3 step process.



Our process is simple and involves 3 steps - Plan, Visualize, and Implement. When you partner with the Makers of Cool, you partake in a process that guaranties quality and professionalism of the highest degree from start to finish of each project.



2| VISUALIZE

SKYVUE,
PITTSBURGH, PA

3| IMPLEMENT

KITCHENS



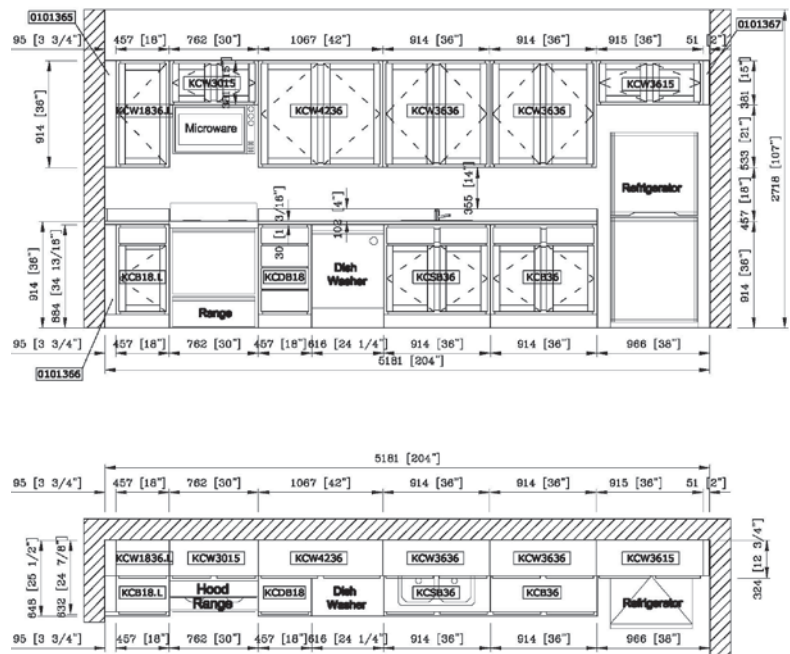

Makers of Cool | 20

KITCHEN CABINETS



Cabinet Construction



- ❶ Full overlay panel, ¾ inch thick solid wood
- ❷ 6-way adjustable European-style hinge with soft-close feature
- ❸ Shelving is ¾ inch thick cabinet-grade plywood with front edge banding
- ❹ Dovetail drawers with solid wood on all sides, full extension
- ❺ Under-mount full extension drawer glides with soft-close feature
- ❻ ½ inch cabinet-grade plywood box, UV coated natural plywood on interior
- ❼ Bracket reinforcements for base cabinet
- ❽ Double-doweled face frame joint
- ❾ Hardwood face frame
- ❿ Door bumpers

Door Styles



SW
Shaker White

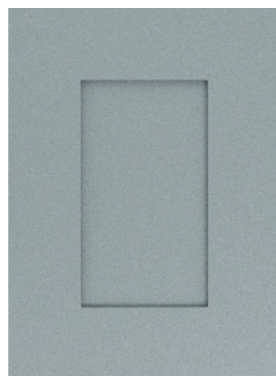

GR
Shaker Gray

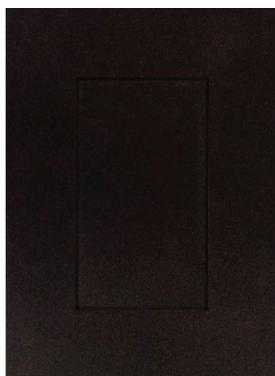

SE
Shaker Espresso



GW
Gray Wash
(Builder Grade)

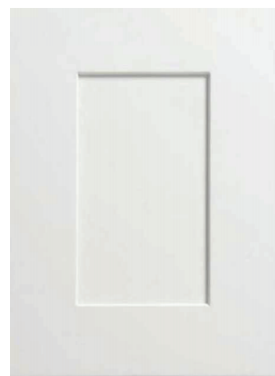

FW
Floral White
(Builder Grade)

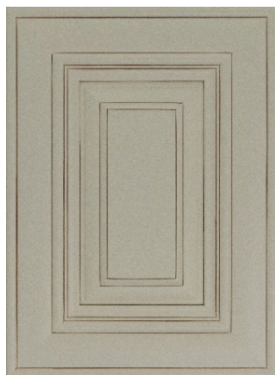

CW
Charleston White



CS
Charleston Saddle

GRANITE OPTIONS



TONGAN WHITE

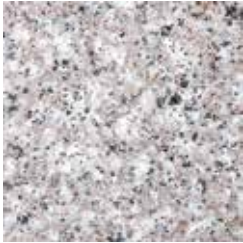

BAINBROOK BROWN



FINISH OPTIONS



BIRCH



NATURAL



WILD CHERRY



CAFELLE





For more information on any of the products shown here,
as well as any of our other product lines please contact a sales representative today.

2588 Jannetides Blvd., Greenfield, IN 46140 | www.uloft.com | 800.423.LOFT (5638)

